

Panel PC, 15"

Panel PC, 15"

15" TFT LCD monitor, XGA

VIA Eden™ EPGA processor or Pentium Series

Fanless Solution available

On-board 10/100BT LAN, Video, Audio, HD and PCI / ISA expansion slots

Panel mounted, IP65

EIA, IEC297 rack mounted, 7U

Industrial grade steel construction

OSD for screen adjustment



SPC-15

Specification	
Processor Type	Pentium series or VIA embedded
Expansion Slots	Pentium series (3 PCI slots) VIA Embedded (1 slot , PCI or ISA)
System Memory	Pentium series (2 slots up to 2G Byte) VIA Embedded (1 slot up to 1G Byte)
I/O Port	Pentium series 10/100 LAN (1), VGA (1), USB (6), Parallel (1), Serial (4), Audio (Speaker, Mic-in, Line-in), PS/2 keyboard & mouse Embedded series 10/100 LAN (4), VGA (1), USB (6), Parallel (1), Serial (4), DIO port Audio (Speaker, Mic-in, Line-in), PS/2 keyboard & mouse
Power Supply	200W, 90-230 VAC, mini ATX, IEC320 type
Display Type	15" TFT LCD active color
Native Resolution	XGA, 1024 x 768 pixels
Viewing Angle	75° horizontal 70° vertical
Brightness	350 nits or cd/m ²
Contrast Ratio	400 : 1 typical
Response Time	8ms
Frequency	50 - 75 Hz
Lamp Life MTBF	50000 hours
Number of color	16.7 million colors
Pixel Pitch	0.255 x 0.255 mm

Environment	
Operating Temperature	0° to +50° C
Storage temperature	-20° to +60° C
Touch screen	Resistive, Capacitive or SAW
Mechanical Dimension	
Color	Black & White (Customized color welcome)
Dimension	<i>IEC297 std Rack mount</i> 311.5H x 483W x 127D mm <i>Panel mount</i> 344.0H x 444W x 127D mm
Weight	7.5 kg
Packaging Size	620L x 520B x 120H mm
Optional OS	Windows Embedded XP Windows CE
Optional Drive	CD-RW, DVD ROM, DVD-RW, FDD



Panel PC 15"

Panel PC 15"

Rack Mount Version

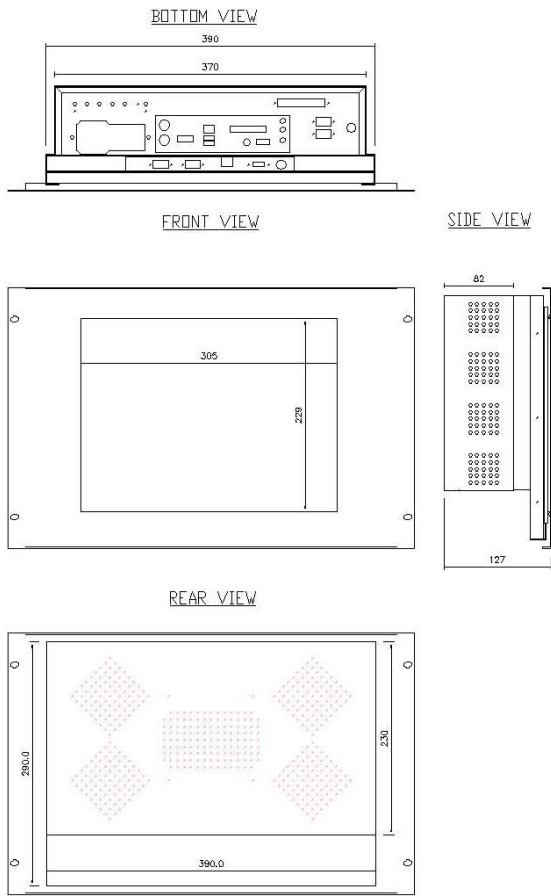

Panel Mount Version

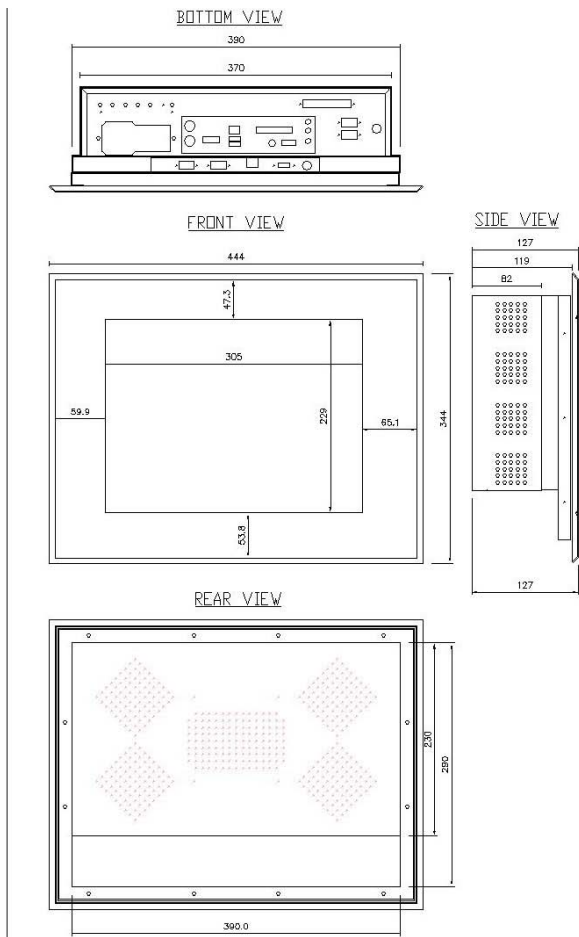

Ordering Information

Part No : **SPC-15PR-E**

1 - Product	2 - LCD Size	3 - Mounting Type	4 - Touch Screen Type	5 - CPU
SPC – Single panel PC	15 – 15.0" 17 – 17.0" 19 – 19.0" 20 – 20.1" 21 – 21.3" 42 – 42.0"	P – Panel Mount D – Desktop Mount V – VESA Mount O – Open frame mount	R – Resistive C – Capacitive S – Surface Acoustic Wave I – Infra-red	P – Pentium Series E – Embedded Series

